

VL-FLWW-C-2332 (Aqua series linear light)

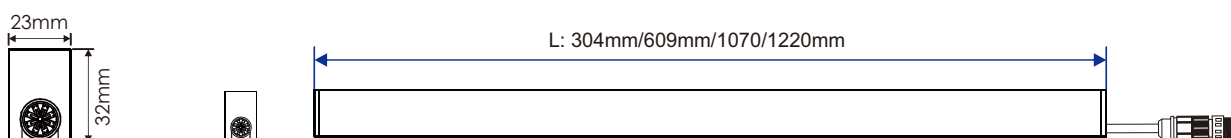
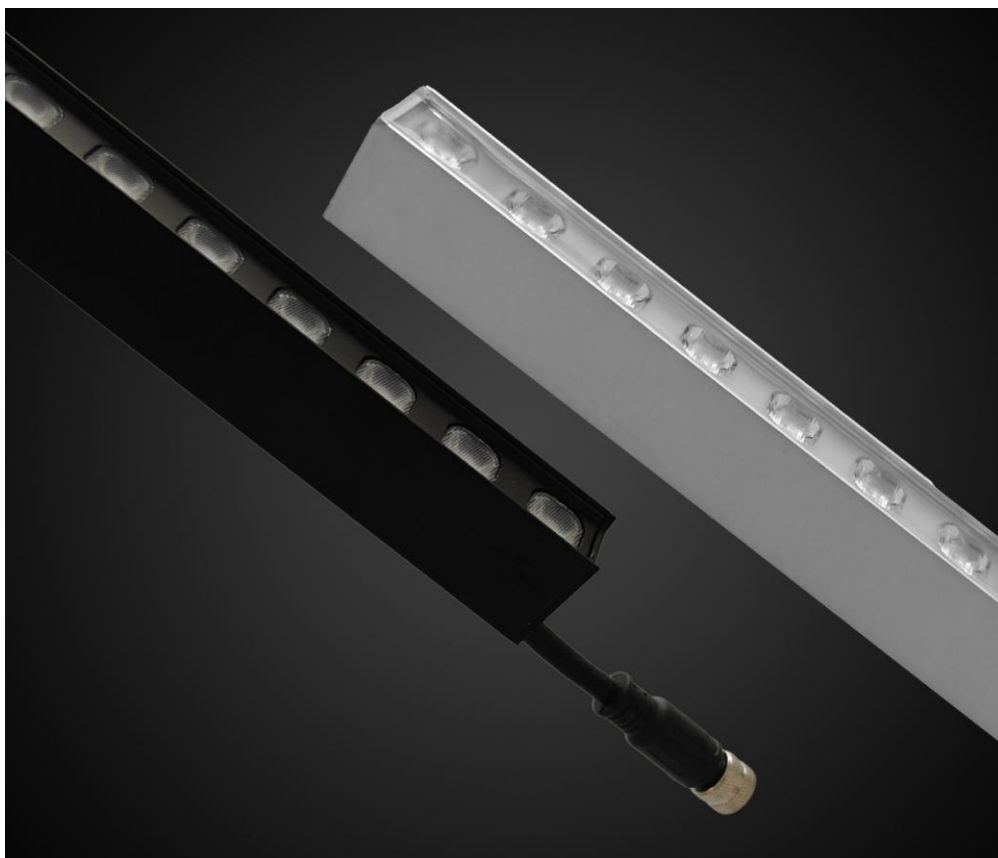

FEATURES

Aqua series offers easy installation with a built-in cable raceway and a quick, plug-and-play connection system. With a high quality PC on top of our wash and graze lens options, this fixture is sure to withstand the elements and provide reliable performance for years to come.

Optics & Electronics

Beam angle available in 20°, 30°, 35°, 40°, 120°, 20*35°.
LED with 3-step MacAdam and CRI 90+ guaranteeing consistency and high quality of light.
DMX512 control protocols.

Customization

Endless fixture length configurations allow for the ultimate freedom of design.

Life Cycle

Long lifetime of L70B10>54,000 hours with 5-year warranty.

VL-FLWW-C-2332 (Aqua series linear light)



SPECIFICATION LOGIC								
FAMILY	POWER W/m	NOMINAL LENGTH	CCT	LENS	BEAM ANGLE	INPUT VOLTAGE	CABLE ENTRY	IP RATING
VL-FLWW-C-2332	8W/m	Length - 304mm	MONO	O - opal ¹	A20 - 20°	24VDC	FM - Female + Male connector	IP68
	16W/m	Length - 609mm	RGBW	C - clear	A30 - 30°			
	30W/m	Length - 1,070mm	DMX		A35 - 35°			
	32W/m	Length - 1,220mm			A40 - 40° O120 - 120° D20*35 - 20°*35°			

1: Opal lens ONLY suitable for beam angle 120°

Order example: VL-FLWW-C-2332-RGB30K-609-OA120-FM

PRODUCT SPECIFICATIONS					
		L304	L609	L1070	L1220
Electrical	Power	8W	16W	30W	32W
	Input Voltage	24V DC			
Physical	Length	304mm	609mm	1070mm	1220mm
	Width x Height	23*32mm			
	Body Finish	Silver or Black(option)			
	IK grade	IK10			
	IP rating	IP68			
	Cable Entry Options	Female and Male at both ends			
	Fixture Connections	Max.10m in one end input			
Optical	Beam Angle	20°, 30°, 40°, 20*35°, 120°			
	Lens Type	Clear and Opal options			
	Lumen Output (4000K, CRI90)	640Lm @30°	1,280Lm @30°	2,400Lm @30°	2,560Lm @30°
	Efficacy (4000K, CRI90)	80Lm/w @30°, 55Lm/w @120°			
	Lumen Maintenance	L70 @ 54,000Hours			
Temperature Range	Storage Temperature	-20~+60 °C			
	Max Ambient Temperature	+55 °C			
	Min Ambient Temperature	-30 °C			

VL-FLWW-C-2332 (Aqua series linear light)



PRODUCT SPECIFICATIONS		L304	L609	L1070	L1220
Electrical	Power	8W	16W	30W	32W
	Input Voltage	24V DC			
Physical	Length	304mm	609mm	1070mm	1220mm
	Width x Height	23*32mm			
	Body Finish	Silver or Black(option)			
	IK grade	IK10			
	IP rating	IP68			
	Cable Entry Options	Female and Male at both ends			
	Fixture Connections	Max.10m in one end input			
Optical	Beam Angle	35°, 120°			
	Lens Type	Clear and Opal options			
	Lumen Output (RGBW)	400Lm @35°	800Lm @35°	1,500Lm @35°	1,600Lm @35°
	Efficacy (RGBW)	50Lm/w @35°, 30Lm/w @120°			
	Lumen Maintenance	L70 @ 54,000Hours			
Temperature Range	Storage Temperature	-20~+60 °C			
	Max Ambient Temperature	+55 °C			
	Min Ambient Temperature	-30 °C			

PRODUCT SPECIFICATIONS		L304	L609	L1070	L1220
Electrical	Power	8W	16W	30W	32W
	Input Voltage	24V DC			
Physical	Length	304mm	609mm	1070mm	1220mm
	Width x Height	23*32mm			
	Body Finish	Silver or Black(option)			
	IK grade	IK10			
	IP rating	IP68			
	Cable Entry Options	Female and Male at both ends			
	No. of Pixels	2pixels/m	4pixels/m	7pixels/m	8pixels/m
Optical	Beam Angle	35°, 120°			
	Lens Type	Clear and Opal options			
	Lumen Output (RGBW)	360Lm @35°	720Lm @35°	1,350Lm @35°	1,440Lm @35°
	Efficacy (RGBW)	45Lm/w @30°, 30Lm/w @120°			
Lumen Maintenance	L70 @ 54,000Hours				
Temperature Range	Storage Temperature	-20~+60 °C			
	Max Ambient Temperature	+55 °C			
	Min Ambient Temperature	-30 °C			

VL-FLWW-C-2332 (Aqua series linear light)



LIGHT DISTRIBUTION

Light distribution example

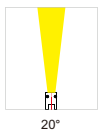
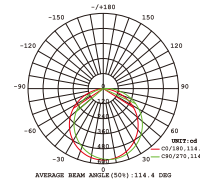
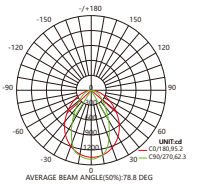
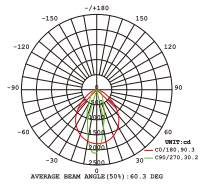
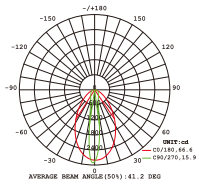

Distance: 50mm
Height of grazer: 4-5m

ULTRA NARROW

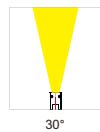

Distance: 50mm
Height of grazer: 3-4m

NARROW

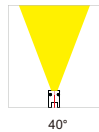

Distance: 100mm
Height of grazer: 2.5-3m

MEDIUM

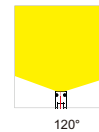

LINEAR LIGHT

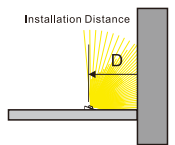

WIRING ELECTRICAL DIAGRAM

ON/OFF WIRING LAYOUT

Power Supply

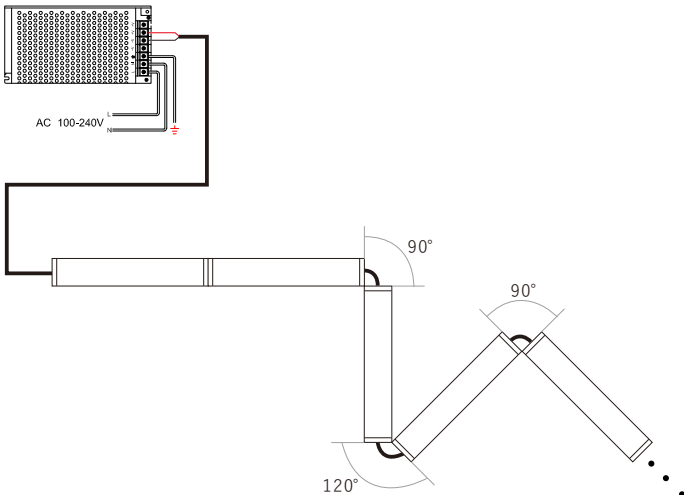

DMX512 WIRING LAYOUT

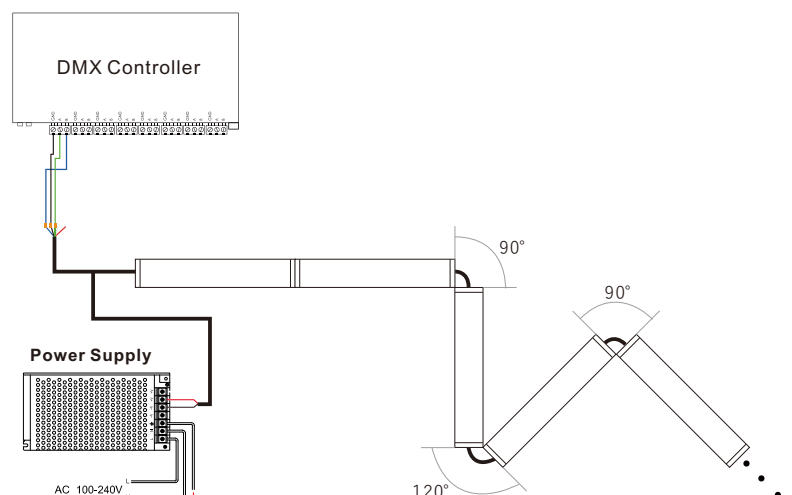

VL-FLWW-C-2332 (Aqua series linear light)



ACCESSORIES AND MOUNTING OPTIONS

MOUNTING CLIPS



EXAMPLES OF INSTALLATION

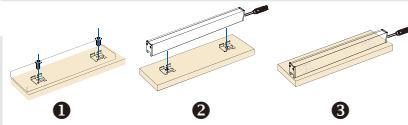

PART NUMBER

2332-FMC

DETAILS

FMC- Fixed mounting clips

60° ADJUSTABLE MOUNTING CLIPS



EXAMPLES OF INSTALLATION

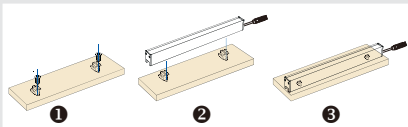

PART NUMBER

2332-AMC-60

DETAILS

AMC- Adjustable mounting clips

EMBEDDED GROUND KIT

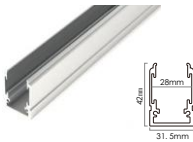

EXAMPLES OF INSTALLATION



PART NUMBER

2332-EBG

DETAILS

EBG- Embedded ground install kit

VISOR

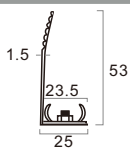

EXAMPLES OF INSTALLATION

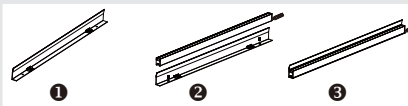

PART NUMBER

2332-VS

DETAILS

VS- Visor

60° ADJUSTABLE VISOR

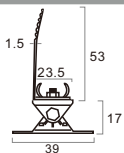

EXAMPLES OF INSTALLATION



PART NUMBER

2332-AVS-60

DETAILS

AVS- Adjustable visor

T-TYPE FEEDING POWER CABLE

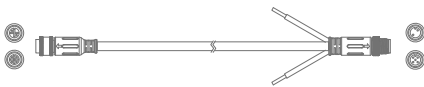

EXAMPLES OF INSTALLATION

/

PART NUMBER

SLLA-TFPC-____MM-2P
SLLA-TFPC-____MM-5P

DETAILS

TFPC- T-type feeding connect power cable

FEEDING POWER CABLE

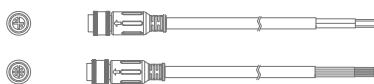

EXAMPLES OF INSTALLATION

/

PART NUMBER

SLLA-FPC-____MM-2P
SLLA-FPC-____MM-5P

DETAILS

FPC- Feeding power cable

EXTENSION CONNECT CABLE



EXAMPLES OF INSTALLATION

/

PART NUMBER

SLLA-EXTC-____MM-2P
SLLA-EXTC-____MM-5P

DETAILS

EXTC- Extension connect power cable